

# PRO XF Water Separators

Redefining Compressed Air Filtration | Water Separators

Flow rates 700 scfm (1189 Nm<sup>3</sup>/hr) to 3000 scfm (5097 Nm<sup>3</sup>/hr)

The PRO XF Water Separator uses centrifugal force to remove 99% of bulk water found in compressed air systems to avert water contamination. PRO XF Water Separators enhance the reliability of a compressed air system, eliminate the problem of costly downtime and are tested in accordance with ISO 8573-9.

Designed as part of the PRO XF range, the PRO XF Water Separator can be used individually or multi-banked with PRO XF Filter Modules to create a space-saving and cost effective filtration solution.

The centrifugal module has been custom engineered to feature unique vanes to eliminate points of low efficiency, and a vortex arrestor to stop re-entrainment - ensuring minimal operating pressure loss and maintaining excellent liquid removal, even at low velocities.

Available in 2", 2 1/2" and 3" threaded and ANSI compatible 150lb (3" and 4") flanged connections for pressures up to 232 psig. No replacement components are required for the PRO XF Water Separator, making it a viable, cost effective solution to removing bulk water from compressed air.

Removes **99%**  
of bulk water  
when tested in  
accordance with  
**ISO 8573-9**



**Unique Centrifugal Module**

Removes 99% of bulk water even at low velocities



**Externally Accessible Drain Valve**

Eliminates the need to access inside the filter housing when servicing the drain



**Threaded & Flanged Connections**

2", 2 1/2", 3" threaded and ANSI compatible 150lb (3" and 4") flanged connections

- **Energy Saving** Operates with consistently low differential pressure, reducing both energy consumption and operating costs
- **Cost Effective** No replacement components are required
- **Space Saving Modular Construction** The PRO XF Water Separator can be installed individually or banked to PRO XF Filter Modules using slim-line connectors and one set of inlet and outlet ports
- **Corrosion Protection** Internal and external electrophoretic coating
- **Externally Accessible Drain Valve** Drain valve can be removed externally, without having to gain access to the internal of the filter. Simply unscrew from the bottom and remove

For further information please visit [www.walkerfiltration.com](http://www.walkerfiltration.com)



# Technical Specification

## PRO XF Water Separator

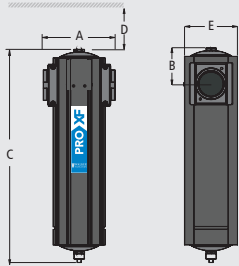

Model XF200WS - XF300WS

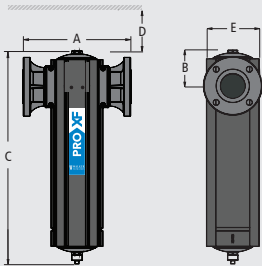

Model XF300FWS

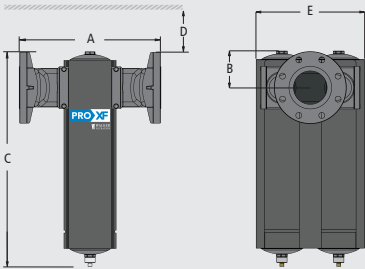

Model XF400FWS

Water separator	Pipe size	Inlet flow rate*		Dimensions inches (mm)						Weight	
		SCFM	Nm <sup>3</sup> /hr	A	B	C	D	E	F	lbs	Kg
XF200WS	2"	700	1189	9.13 (232)	4.57 (116)	25.59 (650)	11.81 (300)	6.73 (171)	N/A	26.0	11.8
XF250WS	2 1/2"	850	1444	9.13 (232)	4.57 (116)	25.59 (650)	11.81 (300)	6.73 (171)	N/A	26.0	11.8
XF300WS	3"	1500	2550	9.13 (232)	4.57 (116)	25.59 (650)	11.81 (300)	6.73 (171)	N/A	26.0	11.8
XF300FWS	3" flanged	1500	2550	13.86 (352)	4.57 (116)	25.59 (650)	11.81 (300)	6.73 (171)	N/A	34.6	15.7
XF400FWS	4" flanged	3000	5097	18.00 (457)	4.57 (116)	25.59 (650)	11.81 (300)	13.50 (343)	N/A	64.6	29.3

Grade	WS	
Maximum recommended operating temperature	176°F	80°C
Minimum recommended operating temperature	35°F	1.5°C
Maximum working pressure	232 psig	16 barg

All PRO XF Water Separators can be multi-banked to PRO XF Filter Modules to create compact and space saving filtration solutions.

Example: Air Purity Classification 1,-,1

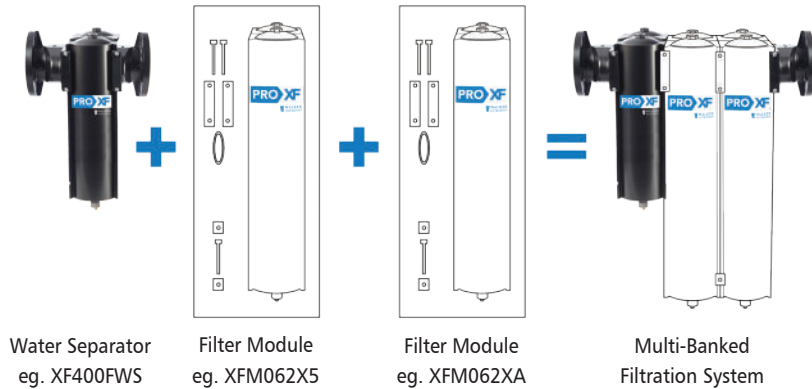

For more information on the full PRO XF range please see the PRO XF product brochure or visit [www.walkerfiltrationlaunches.com/proxf](http://www.walkerfiltrationlaunches.com/proxf)

## Technical notes

1. Water Separators and Coalescing Filters are fitted with float operated automatic drain valves. When high quantities of liquids are anticipated, Walker Filtration recommends the use of electronic drain valves with Water Separators.
2. Water Separators can be multi banked to appropriate PRO XF Filter Modules using the slim-line connectors that are supplied with each Filter Module.
3. Flanged connections are ANSI compatible 150lb (3" and 4") as standard. For DN type flanges contact your sales representative.
4. Threaded connections are NPT to ANSI B2.1 as standard. For Rp (BSP parallel) to ISO 7/1 connections, please contact your sales representative.



THE QUEEN'S AWARDS  
FOR ENTERPRISE:  
INNOVATION  
2016



**Walker Filtration Inc**  
4748 Pacific Avenue,  
Erie, PA 16506,  
USA.  
t: +1 814 836 2900  
f: +1 814 836 7921  
e: [usa@walkerfiltration.com](mailto:usa@walkerfiltration.com)  
[www.walkerfiltration.com](http://www.walkerfiltration.com)

**Walker Filtration Ltd**  
Birtley Road, Washington,  
Tyne & Wear, NE38 9DA,  
United Kingdom.  
t: +44 (0) 191 417 7816  
f: +44 (0) 191 415 3748  
e: [sales@walkerfiltration.co.uk](mailto:sales@walkerfiltration.co.uk)  
[www.walkerfiltration.com](http://www.walkerfiltration.com)

**Walker Filtration PTY Ltd**  
16-18 Lindon Court,  
Tullamarine, Victoria, 3043,  
Australia.  
t: +61 (0) 3 9330 4144  
f: +61 (0) 3 9330 4177  
e: [sales@walkerfiltration.com.au](mailto:sales@walkerfiltration.com.au)  
[www.walkerfiltration.com.au](http://www.walkerfiltration.com.au)

**Walker Filtration Ltd Japan**  
Hulic Gaenmae Building, 2nd Floor  
2-7-26 KitaAoyama, Minatoku  
Tokyo, 107-0061, Japan.  
t: +81 (0)3 6890 6911  
f: +81 (0)3 6685 2974  
e: [japan@walkerfiltration.com](mailto:japan@walkerfiltration.com)  
[www.walkerfiltration.com](http://www.walkerfiltration.com)